

ALLDAY  
& MILLER



Arklay Close, Uxbridge, UB8 3WP  
£1,600

 2  2  1  C



## Arklay Close, Uxbridge, UB8 3WP

**£1,600**

- Stylish Ground Floor Apartment
- Two Bathrooms
- Allocated Parking
- Opposite Hillingdon Hospital
- Two Double Bedroom
- Totally Refurbished Throughout
- Exclusive Gated Development
- Wood Flooring

## Description

The accommodation comprises an entrance hallway with storage cupboard, a bright and airy living room, brand new high gloss kitchen with integral appliances, two double bedrooms with the master benefiting from a newly fitted stylish en suite shower room and a brand new contemporary bathroom suite.

## Outside

Surrounding the development you have communal gardens with secure allocated parking set behind gates.

## Situation

Arklay Close is a modern gated development located opposite Hillingdon Hospital and a short stroll from Hillingdon Hill with its local shops and golf course. Within a two minute walk there are bus stops which facilitate the U1, U2, U3, U4, U5, U7 and more. Uxbridge Town centre is approximately a mile away with its array of shops, restaurants, bars and Metropolitan/Piccadilly line train station with its direct access to Baker Street and the City. The property is conveniently located for West Drayton train station (Elizabeth line which connects to Paddington in approx. 20 minutes), Stockley Park, Hillingdon Hospital, Brunel University and Heathrow Airport as well as a number of motorway links including the A40/M40, M4 and M25 with their links to London and the Home Counties.



## Floor Plans



### Arklay Close UB8

Approximate Gross Internal Floor Area = 56.3 sq m / 607 sq ft

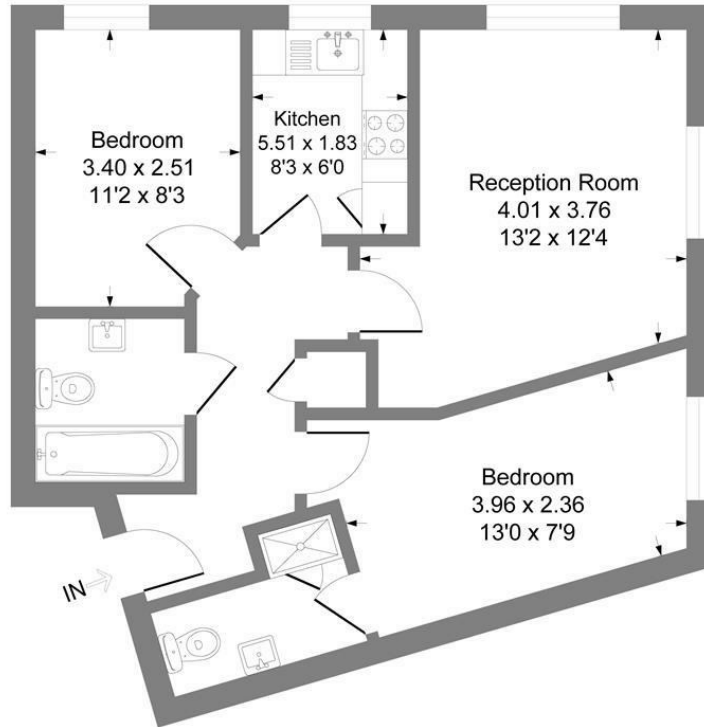

#### Ground Floor

Illustration for identification purposes only, measurements are approximate, not to scale.

## Area Map

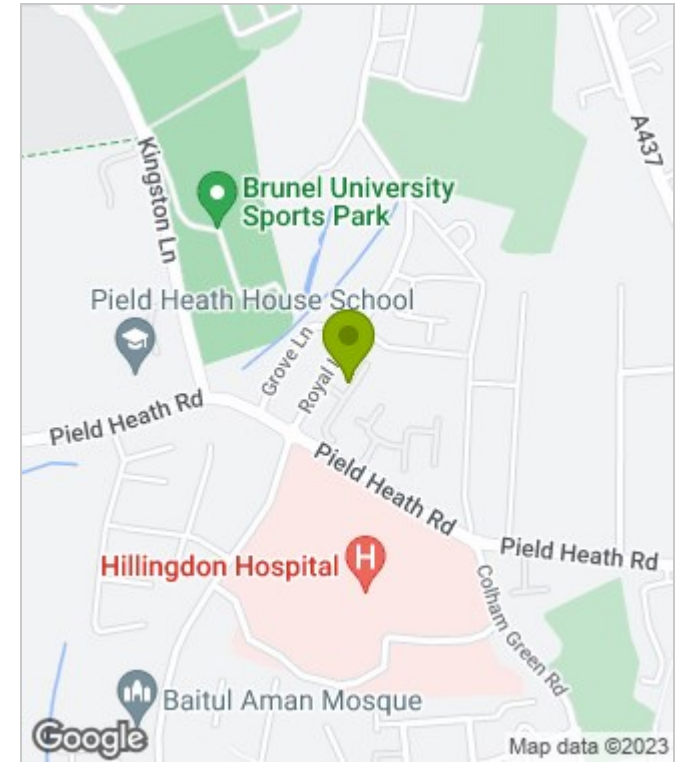

## Energy Performance Graph

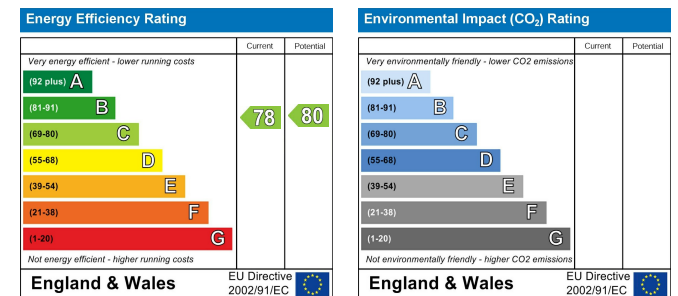

These particulars, whilst believed to be accurate are set out as a general outline only for guidance and do not constitute any part of an offer or contract. Intending purchasers should not rely on them as statements of representation of fact, but must satisfy themselves by inspection or otherwise as to their accuracy. No person in this firm's employment has the authority to make or give any representation or warranty in respect of the property.